

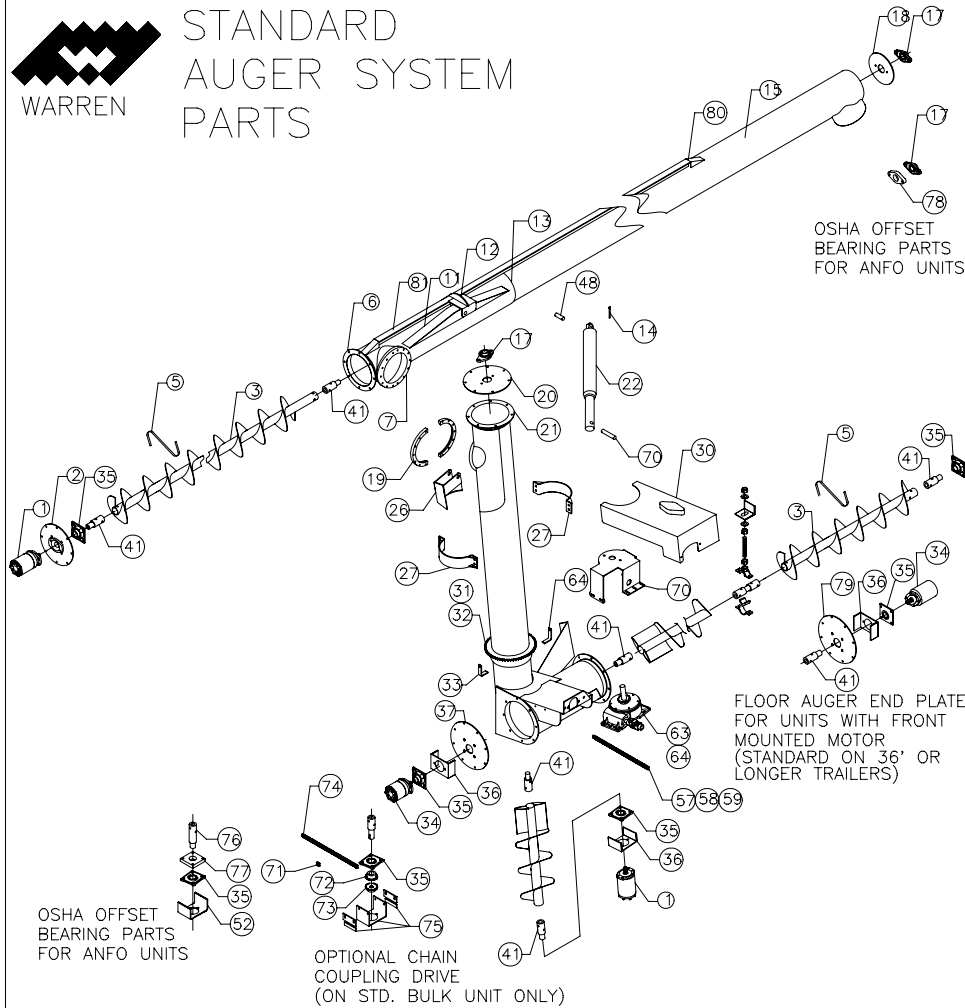

STANDARD AUGER SYSTEM PARTS



ITEM	PART#	DESCRIPTION
1	400-0003	DISCHARGE/VERTICAL HYD MOTOR
2	700-00028	DISCHARGE MOTOR MOUNTING PLATE
3	700-00028	AUGER RAW MATERIAL
4	700-00101	TOP RIVET
5	700-00103	WON FIGHTING WRAP
6	700-0003	MACHINED CROSSOVER RING
7	700-00028	DISCHARGE BONNET
8	700-00028	BAM BRACKET STEFFNER
9	700-00028	BAM BRACKET STEFFNER
10	700-00028	BAM BRACKET STEFFNER END CAP
11	700-00028	BAM BRACKET
12	700-00028	BAM BRACKET PAD
13	700-00028	BAM BRACKET PAD
14	700-00100	PIVOT PIN FOR HYD CYLINDER
15	700-0003	DISCHARGE TUBE RAW MAT
16	700-0003	DISCHARGE TUBE DOWN SPOUT
17	700-80002	HOLE FLANGE BEARING
18	700-00028	FLY RING ASSEMBLY
19	700-00028	FLY RING ASSEMBLY
20	700-0008	VERTICAL TUBE TOP PLATE
21	700-0003	BOILING ANGLE RING
22	400-0009	MACHINED CROSSOVER RING
23	700-0009	VERTICAL TUBE BONNET
24	700-0009	BAM BRACKET STEFFNER
25	700-0009	BAM BRACKET PAD
26	700-0009	PIVOT BAND ASSEMBLY
27	700-0008	WEAR BAND
28	700-0008	VERTICAL TUBE RAW MATERIAL
29	700-0008	VERTICAL TUBE RAW MATERIAL
30	700-0020	VERTICAL TUBE CHAIN GUARD
31	700-0012	VERTICAL TUBE SPROCKET(SINGLE #60)
32	700-0012	VERTICAL TUBE SPROCKET(SINGLE #80)
33	700-0026	TURN DEVICE CHAIN GUARD BRACE
34	400-0001	FLOOR AUGER HYD MOTOR
35	700-8001	HOLE FLANGE BEARING
36	700-0021	MOTOR MOUNTING BRACKET
37	700-0007	FLOOR AUGER END PLATE
38	700-0027	PIVOT CHANNEL FOR T-BAR
39	700-0003	BOILING ANGLE RING
40	700-0003	STEP SPINED BUSHING
41	700-0024	TURN DEVICE GUSSET
42	700-0024	FLOOR AUGER FLIBBER
43	700-0006	AUGER BEARING SHAFT
44	700-0006	HWY BEARING
45	700-0006	HWY BEARING
46	700-0006	HEADED ROD
47	700-0008	3" X 3" DISCHARGE AUGER CYLINDER PIN
48	700-0008	3" X 3" DISCHARGE AUGER CYLINDER PIN
49	700-0008	3" X 3" DISCHARGE AUGER CYLINDER PIN
50	700-0007	TRANSITION ASSEMBLY
51	700-0007	TRANSITION ASSEMBLY
52	700-8000	UNIVERSAL JOINT
53	700-8000	UNIVERSAL JOINT
54	700-8001	DOUBLE #60 MASTER LINK
55	700-8002	SINGLE #60 MASTER LINK
56	700-8002	SINGLE #60 MASTER LINK
57	700-8000	SINGLE #60 CHAIN
58	700-8002	DOUBLE #60 CHAIN
59	700-8000	SINGLE #60 TURN DEVICE SPROCKET
60	700-8001	DOUBLE #60 TURN DEVICE SPROCKET
61	700-8001	DOUBLE #60 TURN DEVICE SPROCKET
62	700-8002	SINGLE #60 TURN DEVICE SPROCKET
63	700-0010	TURN DEVICE GEAR BOX ASSEMBLY
64	700-0021	FLOOR AUGER CHAIN GUARD BRACE
65	400-0003	DISCHARGE/VERTICAL HYD MOTOR
66	700-0008	VERTICAL AUGER BRACKET
67	700-0008	VERTICAL AUGER BRACKET GUSSET
68	700-0008	VERTICAL AUGER FLIBBER
69	700-0009	VERTICAL AUGER RAW MATERIAL
70	700-8002	DOUBLE #60 MASTER LINK
71	700-8001	KEY-WAY SPROCKET
72	700-8001	KEY-WAY SPROCKET
73	700-8001	KEY-WAY SPROCKET
74	700-0012	STEP SPINED BUSHING
75	700-0021	MOTOR MOUNT BRACKET FOR CHAIN COUPLING DRIVE
76	700-0001	NITRATE STEP SPINED BUSHING
77	700-0001	NITRATE BEARING SPACER ASSY.
78	700-0001	NITRATE BEARING SPACER ASSY.
79	700-0022	FLOOR AUGER END PLATE FOR FRONT MOUNT MOTOR
80	700-0022	FLOOR AUGER END PLATE FOR FRONT MOUNT MOTOR
81	700-0022	FLOOR AUGER END PLATE FOR FRONT MOUNT MOTOR